

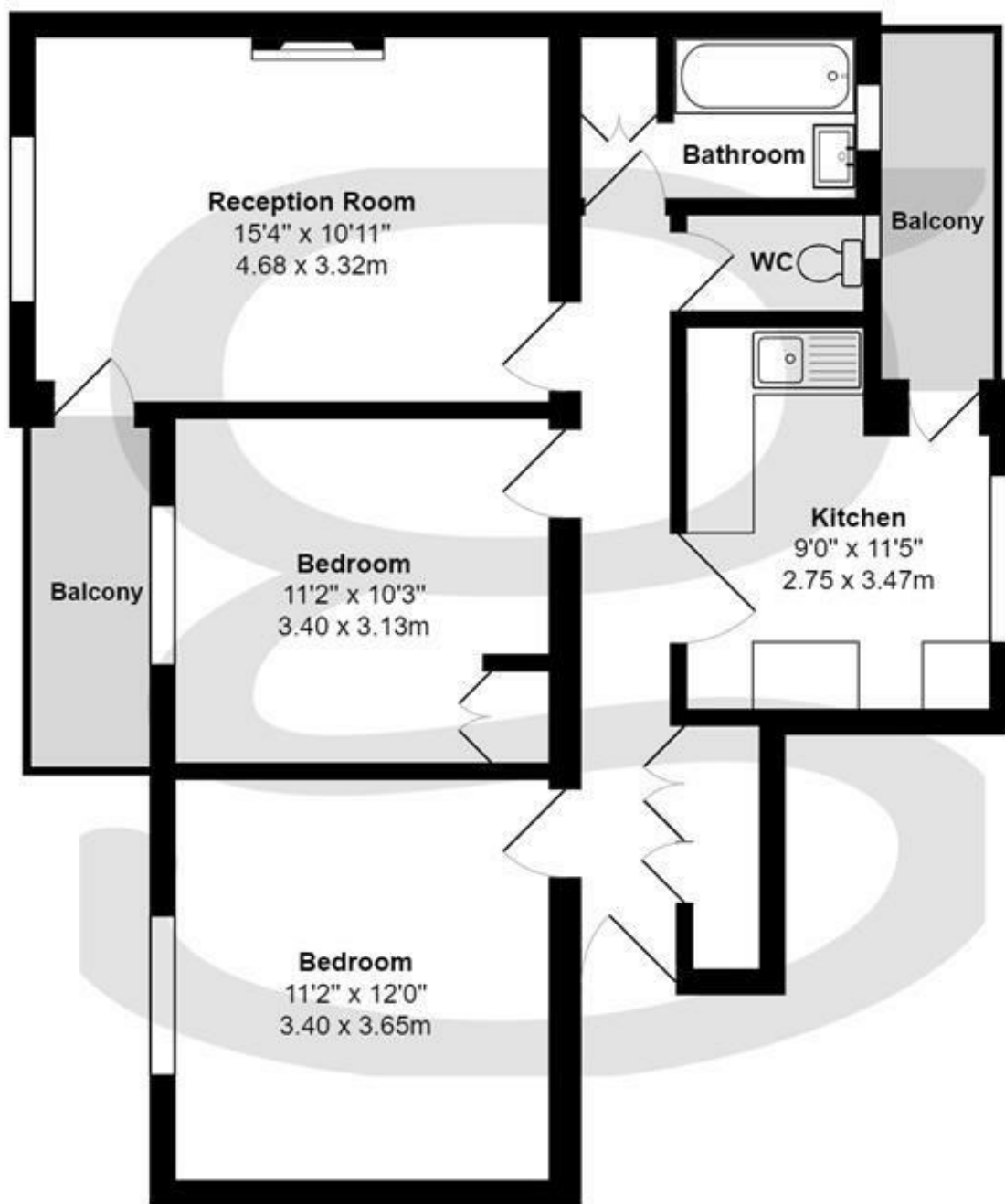

Boundary Road, St Johns Wood, NW8 £450,000 Subject to contract

This is a great opportunity to live within a short stroll to the Boundary Road shops, bars, restaurants and the famous Abbey Road studios. The property is arranged as a large reception with door to balcony, a separate kitchen with further balcony, two good sized double bedrooms, family bathroom and separate w/c. The apartment offers double glazing throughout and access to communal gardens. Close to Swiss Cottage (Jubilee Line), South Hampstead (Overground to Euston) and a short walk to Finchley Road (Metropolitan line) and the numerous Buses available from Finchley Road and Swiss Cottage. The O2 centre, cinema complex and Supermarkets are within easy walk.





2nd Floor

Greenaway House, Boundary Road NW8

Total Area: 699 ft² ... 64.9 m² (excluding balcony)

Floor plans are for identification and guideline purposes only, not to scale
Compliant RICS code of measuring practice

Property Overview

Location	St Johns Wood, NW8
Price	Asking Price £450,000
Bedrooms	2
Bathrooms	1
Receptions	1
Tenure	Leasehold
Council	Camden
Tax Band	C
Current Ground Rent	Approx £10
Service Charge	Approx £1,535 Per Annum
Term	Leasehold - 125 years from 24/04/2000

Key Features

- Reception Room
- Separate Kitchen
- 2 Bedrooms
- Bathroom
- 2 Balconies
- Separate W/C
- Passenger Lift
- Communal Garden
- Great Location
- Close to Transport Links

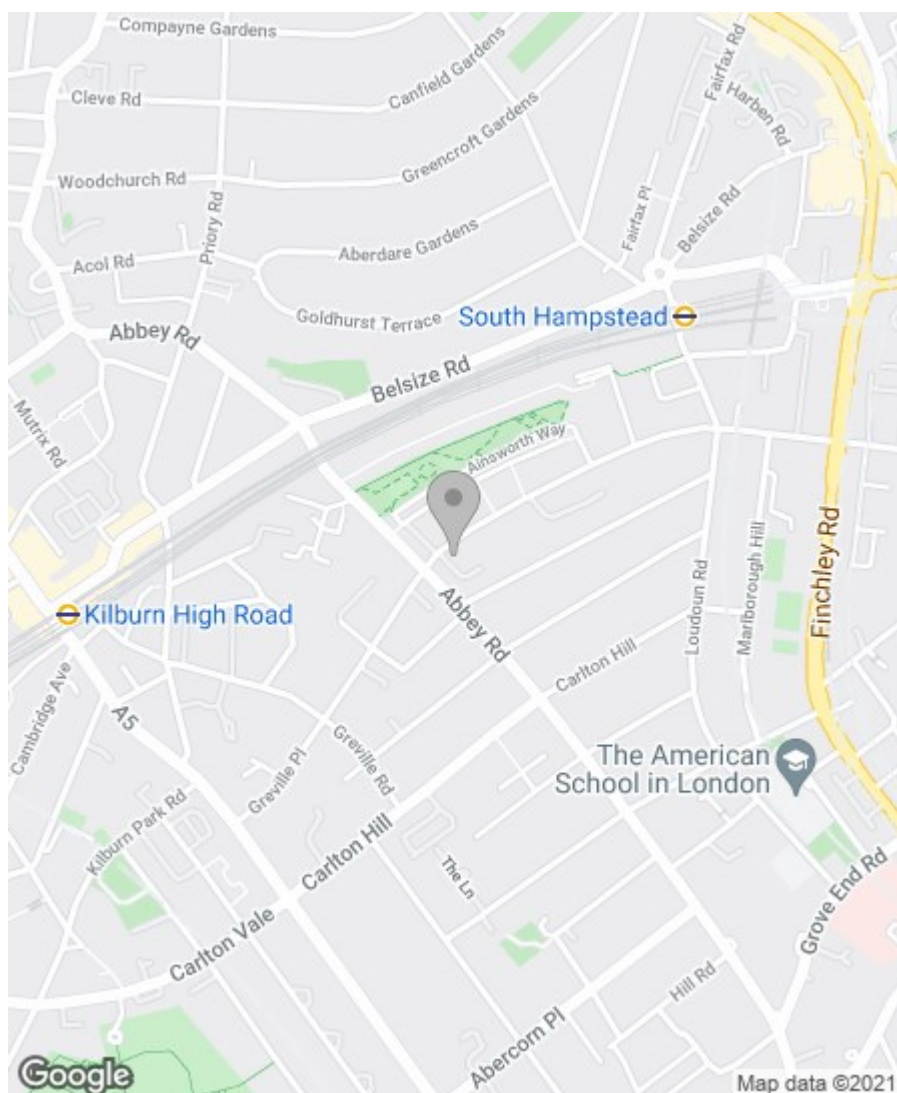

Energy Efficiency Rating

	Current	Potential
<i>Very energy efficient - lower running costs</i>		
(92 plus) A		
(81-91) B		
(69-80) C		
(55-68) D	66	68
(39-54) E		
(21-38) F		
(1-20) G		
<i>Not energy efficient - higher running costs</i>		

England & Wales

EU Directive
2002/91/EC



Environmental Impact (CO₂) Rating

	Current	Potential
<i>Very environmentally friendly - lower CO₂ emissions</i>		
(92 plus) A		
(81-91) B		
(69-80) C		
(55-68) D	63	66
(39-54) E		
(21-38) F		
(1-20) G		
<i>Not environmentally friendly - higher CO₂ emissions</i>		

England & Wales

EU Directive
2002/91/EC



IMPORTANT NOTICE: All of the information is intended only as a guide to a prospective purchaser and does not constitute any part of an offer or contract. Any measurements or distances referred to herein are approximate only. Any information contained herein (whether in the text, plans or photographs) is given in good faith and cannot be relied upon as being a statement or representation of fact. Should you proceed with the purchase of the property, your solicitor must verify these details. We have not carried out a detailed survey nor tested the services, appliances and specific fittings. In accordance with current legislation we would advise you that the measurements on these particulars are imperial. The formula for conversion to metric is as follows: 1' (one foot) = 30.4cm (centimetres), 1m (one metre) = 3'29 (feet).

